

WOODFORD WALK, THORNABY, STOCKTON-ON-TEES, TS17 0LT



- ▲ A Sensibly Priced Three Bedroom Home Which Would Suit Both First Time and Family Buyers
- ▲ Situated Within This Popular Thornaby Location Close to A Good Range of Amenities
- ▲ Spacious Lounge with Double Glazed French Doors to The Rear Garden
- ▲ Breakfast Kitchen with A Good Range of Fitted Units & Built-In Oven & Hob
- ▲ Separate Utility Room
- ▲ Three First Floor Bedrooms
- ▲ Bathroom with White Three Piece Suite
- ▲ Electric Wall Heaters & Double Glazing
- ▲ Enclosed Lawned Garden with Decking & Communal Parking Area to The Front

£105,000

www.michaelpoole.co.uk

Michael Poole
sales | lettings | auctions



Situated within this popular Thornaby location close to a good range of amenities, a sensibly priced three bedroom home which would suit both first time and family buyers.

GROUND FLOOR

LOUNGE - 4.17m (13'8") x 3.48m (11'5") reducing to 2.97m (9'9")

BREAKFAST KITCHEN - 5.23m x 2.26m (17'2" x 7'5")

UTILITY ROOM - 2.29m x 1.75m (7'6" x 5'9")

FIRST FLOOR

LANDING

BEDROOM ONE - 4.17m x 2.9m (13'8" x 9'6")

BEDROOM TWO - 2.97m x 2.26m (9'9" x 7'5")

BEDROOM THREE - 2.3m x 2.26m (7'7" x 7'5")

BATHROOM - 1.93m x 1.73m (6'4" x 5'8")

TO VIEW: Tel: 01642 763636
Myton Park, Myton Road, Ingleby Barwick, TS17 0WA

www.michaelpoole.co.uk



WOODFORD WALK, TS17 0LT



EXTERNALLY

PARKING & GARDEN

There is a communal parking area to the front of the house. To the rear there is an enclosed garden which is mainly laid to lawn with a decked area.

AGENT NOTE:

There is a service charge of £34 PCM to People for Places.

AGENTS REF: - DC/LS/ING240099/19042024

Council Tax Band: A **Tenure:** Freehold

TO VIEW: Contact our Ingleby Barwick office on
Tel: 01642 763636



Do you have a property you
need to sell
before you can buy?

Michael Poole offers **FREE, no obligation** market appraisals and gives you guidance on the **BEST PRICE** you can expect in the current market

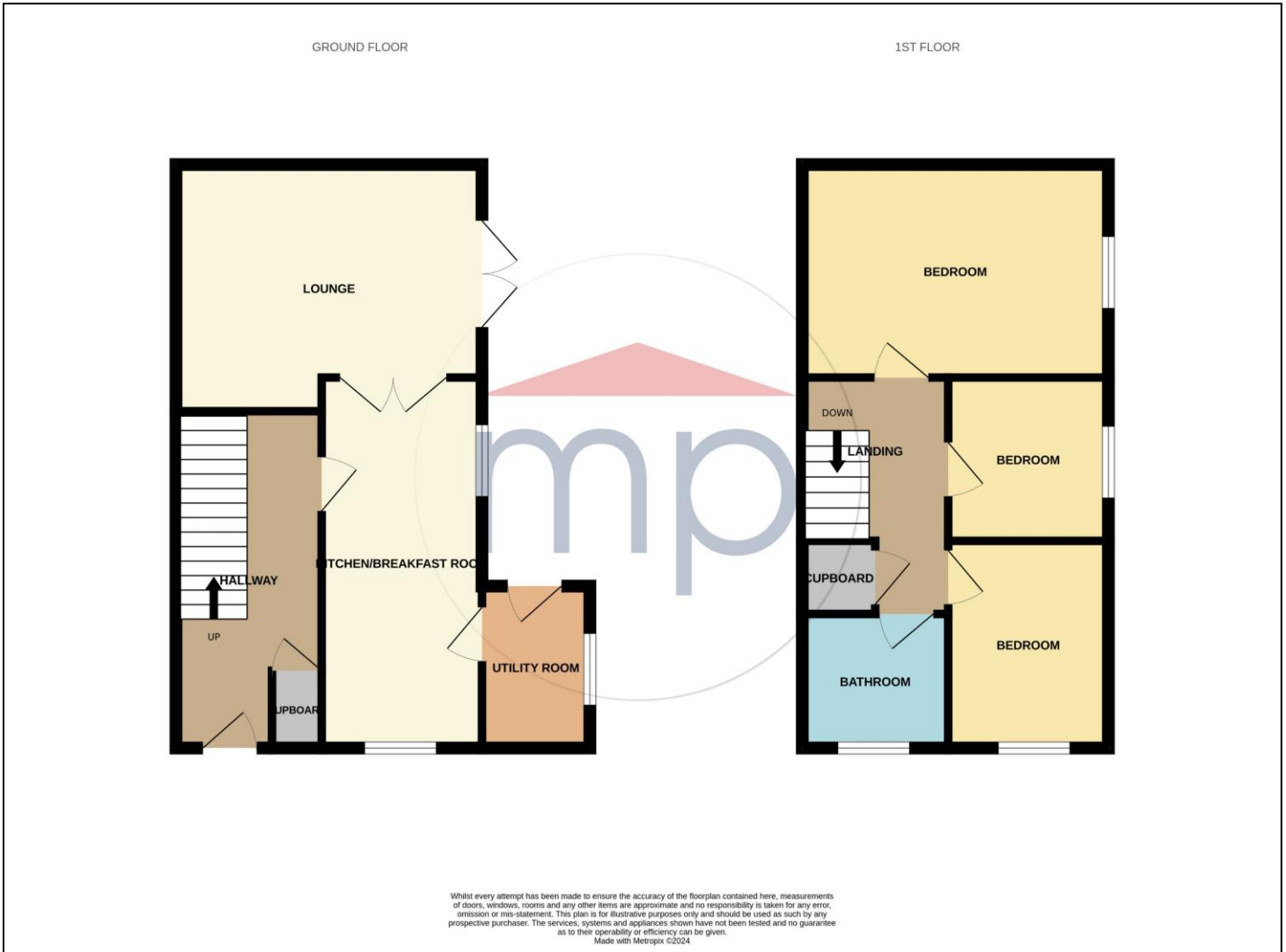

Whilst every attempt has been made to ensure the accuracy of the floorplan contained here, measurements of doors, windows, rooms and any other items are approximate and no responsibility is taken for any error, omission or mis-statement. This plan is for illustrative purposes only and should be used as such by any prospective purchaser. The services, systems and appliances shown have not been tested and no guarantee as to their operability or efficiency can be given.
Made with Metropix 5/2024

The information provided about this property does not constitute or form part of an offer or contract, nor may it be regarded as representations. All interested parties must verify accuracy and your solicitor must verify tenure and lease information, fixtures and fittings and, where the property has been recently constructed, extended or converted, that planning/building regulation consents are in place. All dimensions are approximate and quoted for guidance only, as are floor plans which are not to scale, and their accuracy cannot be confirmed. Reference to appliances and/or services does not imply that they are necessarily in working order or fit for the purpose. We offer our clients an optional conveyancing service, through panel conveyancing firms, via MWU and we receive on average a referral fee of one hundred and thirty pounds, only on completion of the sale. If you do use this service, the referral fee is included within the amount that you will be quoted by our suppliers. All quotes will also provide details of referral fees payable.

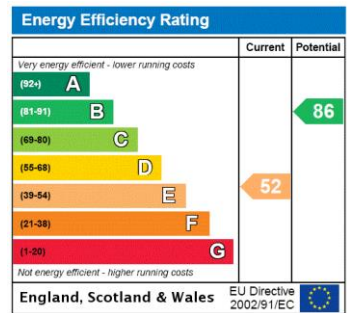

TO VIEW: Contact our Ingleby Barwick Office on Tel: **01642 763636**
Myton Park, Myton Road, Ingleby Barwick, TS17 0WA

www.michaelpoole.co.uk

Michael Poole
sales | lettings | auctions